

4 OUR PROPOSAL

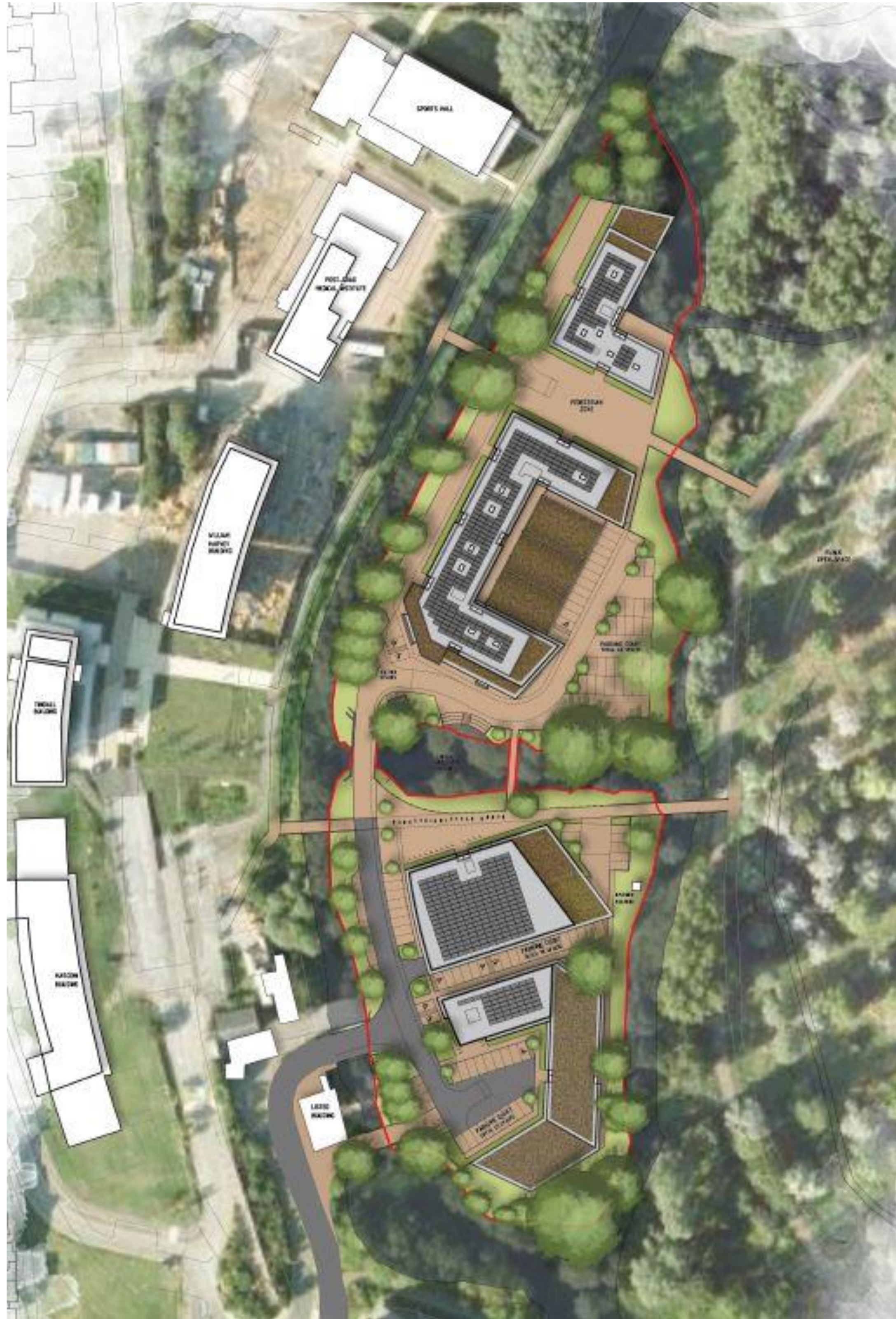

Proposed Master Plan

Rivermead North

- 315 Student Accommodation Rooms (with shared kitchen/living rooms);
- Retention of the pool, snooker and bowling centre;

Rivermead South

- The redevelopment of existing commercial buildings to provide a total of 10,000 sq.m New Flexible Office, Light Industrial, Research & Development Floor Space (Use Class B), with potential university teaching space or complimentary university uses;

Overall Site

- Landscaping and ecological benefits, including creation of a new wetland; and
- New bridges to link the site to Anglia Ruskin University and the Local Nature Reserve.



Block A as seen from Local Nature Reserve